



For complete warranty details
visit www.AspenMfg.com

Product Features and Specifications

Application Versatility

Upflow or horizontal right as shipped (field convertible for downflow or horizontal left applications). Can be AHRI certified with most brands of air conditioners or heat pumps. ETL-listed for use with all major refrigerants when proper metering device is used.

Low Leakage Cabinet

Less than 2% air leakage from cabinet when tested in accordance with ASHRAE standard 193. Unit must be installed according to installation instructions. Sturdy, fully insulated galvanized steel cabinet with knockout for duct return.

Air Moving System

Constant torque ECM speeds and torques are controlled by software embedded in the motor to maintain constant torque. Motors are pre-programmed with speeds and torques at the factory for optimal performance and reliability. Direct drive blowers circulate air quietly and efficiently. Rail mounted blowers provide easy removal for service and maintenance.

Electronic Control Board

An electronic board controls the functioning of the system, reducing moving parts. The board provides a blower time delay to maximize heat/cool extraction and offers an integrated fuse for additional protection.

All Aluminum Coil

High efficiency rifled aluminum tubes and enhanced aluminum fins provide maximum heat transfer. All coils factory leak tested with two-stage pressure decay and mass spectrometer process, then nitrogen pressurized, and factory-sealed for maximum reliability. Available with either factory-installed orifice or TXV metering device. Field-installable bolt-on TXVs are also available. Access door allows for easy coil cleaning.

Options

See Options menu.



LEM SERIES AIR HANDLER

High Efficiency

Multi-Position, Aluminum Coil

HEATING AND COOLING PERFORMANCE AND ELECTRICAL DATA

MODEL	ELECTRIC HEAT KIT MODEL	PERFORMANCE DATA				ELECTRICAL DATA			
		HEATING (kW)		HEATING CAPACITY		MINIMUM CIRCUIT AMPACITY (MCA)		MAX BREAKER OR FUSE SIZE	
		208V	240V	208V	240V	208V	240V	208V	240V
LEM24A-E	N(C,T)S00	0.0	0.0	0.0	0.0	3.5	3.5	15.0	15.0
	N(C,T)S03	2.3	3.0	7.8	10.2	17.0	19.1	20	20
	N(C,T)S05	3.6	4.8	12.3	16.4	25.1	28.5	30	30
	N(C,T)S06	4.5	6.0	15.4	20.5	30.5	34.8	35	35
	N(C,T)S08	6.0	8.0	20.5	27.3	39.6	45.2	40	50
	N(C,T)S10	7.2	9.6	24.6	32.8	46.8	53.5	50	60
LEM24F-J LEM36A-E	N(C,T)M00	0.0	0.0	0.0	0.0	5.1	5.1	15	15
	N(C,T)M03	2.3	3.0	7.8	10.2	18.6	20.8	20	25
	N(C,T)M05	3.6	4.8	12.3	16.4	26.8	30.1	30	35
	N(C,T)M06	4.5	6.0	15.4	20.5	32.2	36.4	35	40
	N(C,T)M08	6.0	8.0	20.5	27.3	41.2	46.8	45	50
	N(C,T)M10	7.2	9.6	24.6	32.8	48.4	55.1	50	60
	N(C,T)M15	7.2/3.6	9.6/4.8	24.6/12.3	32.8/16.4	48.4/21.6	55.1/25	50/25	60/25
LEM36F-J LEM48A-E LEM60A-E	N(C,T)L00	0.0	0.0	0.0	0.0	9.5	9.5	15	15
	N(C,T)L03	2.3	3.0	7.8	10.2	23	25.1	25	30
	N(C,T)L05	3.6	4.8	12.3	16.4	31.1	34.5	35	35
	N(C,T)L06	4.5	6.0	15.4	20.5	36.5	40.8	40	45
	N(C,T)L08	6.0	8.0	20.5	27.3	45.6	51.2	50	60
	N(C,T)L10	7.2	9.6	24.6	32.8	52.8	59.5	60	60
	N(C,T)L15	7.2/3.6	9.6/4.8	24.6/12.3	32.8/16.4	52.8/21.6	59.5/25	60/25	60/25
LEM48F-J LEM60F-J	N(C,T)X00	0.0	0.0	0.0	0.0	9.5	9.5	15	15
	N(C,T)X03	2.3	3.0	7.8	10.2	23	25.1	25	30
	N(C,T)X05	3.6	4.8	12.3	16.4	31.1	34.5	35	35
	N(C,T)X06	4.5	6.0	15.4	20.5	36.5	40.8	40	45
	N(C,T)X08	6.0	8.0	20.5	27.3	45.6	51.2	50	60
	N(C,T)X10	7.2	9.6	24.6	32.8	52.8	59.5	60	60
	N(C,T)X15	7.2/3.6	9.6/4.8	24.6/12.3	32.8/16.4	52.8/21.6	59.5/25	60/25	60/25
	N(C,T)X20	7.2/7.2	9.6/9.6	24.6/24.6	32.8/32.8	52.8/43.3	59.5/50	60/45	60/50

LEM SERIES AIR HANDLER

High Efficiency

Multi-Position, Aluminum Coil

AIR HANDLER CHASSIS NOMENCLATURE

LEM	24	D	G
LEM= 240v Constant torque ECM Multi-Position Air Handler	Nominal Tonnage	D= Coil Size	Metering device 4= non-bleed A/C or H/P R410 TXV 6= 20% bleed A/C or H/P R410 TXV B= 20% bleed A/C or H/P R410 TXV G= R410A Piston F= R-22 Piston X= non-bleed A/C or H/P R22TXV

ELECTRIC HEAT KIT NOMENCLATURE

N	C	M	03
N = ELECTRIC HEAT KIT	C = Circuit Breaker T = Terminal Block	S= 24 M = 30 - 36 L = 36 - 60 X = 48 - 60	Heat Strip 00 = 0 KW 03 = 3 KW 05 = 5 KW 06 = 6 KW 08 = 8 KW 10 = 10 KW 15 = 15 KW 20 = 20 KW

LEM SERIES AIR HANDLER

High Efficiency

Multi-Position, Aluminum Coil

LEM BLOWER DATA														
MODEL	SPEED TAP	MOTOR			CFM VS EXTERNAL STATIC									
		HP	AMPS	VOLTAGE	0.1	0.2	0.3	0.4	0.5	0.6	0.7	0.8	0.9	1.0
LEM24A-E	TAP 5	1/3	2.4	240	1015	990	960	930	910	880	850	830	790	700
	TAP 4				1005	975	945	810	880	865	830	795	775	735
	TAP 3				895	865	830	795	750	740	710	675	630	610
	TAP 2				755	725	705	675	630	610	575	535	500	450
	TAP 1				685	655	620	600	550	540	500	460	400	350
LEM24F-J LEM36A-E	TAP 5	1/2	4.1		1350	1320	1300	1260	1225	1190	1165	1125	1090	1050
	TAP 4				1200	1150	1100	1080	1060	1030	990	960	895	850
	TAP 3				910	895	880	845	800	765	705	665	620	585
	TAP 2				855	835	780	735	675	635	580	550	510	465
	TAP 1				725	705	675	620	565	540	485	465	410	380
LEM36F-J LEM48A-E LEM60A-E	TAP 5	1	7.6		1725	1710	1675	1635	1615	1560	1520	1475	1455	1415
	TAP 4				1560	1520	1475	1435	1415	1370	1350	1325	1275	1250
	TAP 3				1350	1300	1275	1230	1200	1175	1130	1100	1060	1030
	TAP 2				1180	1140	1100	1075	1050	1010	975	930	900	800
	TAP 1				990	945	910	880	850	800	775	680	625	600
LEM48F-J LEM60F-J	TAP 5	1	7.6		2100	2070	2025	1985	1965	1920	1900	1850	1830	1780
	TAP 4				1960	1930	1880	1850	1815	1780	1760	1725	1690	1650
	TAP 3				1780	1745	1705	1650	1615	1575	1515	1500	1450	1430
	TAP 2				1600	1560	1520	1480	1435	1390	1350	1300	1250	1200
	TAP 1				1460	1415	1350	1300	1275	1230	1180	1125	1070	1010

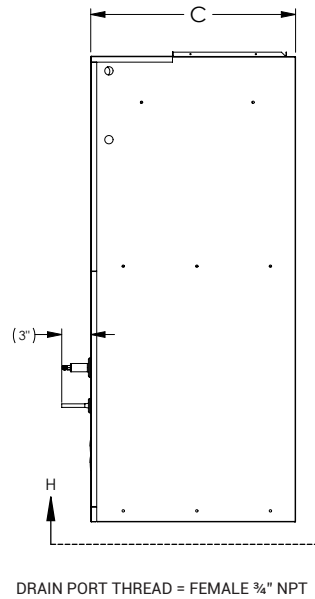
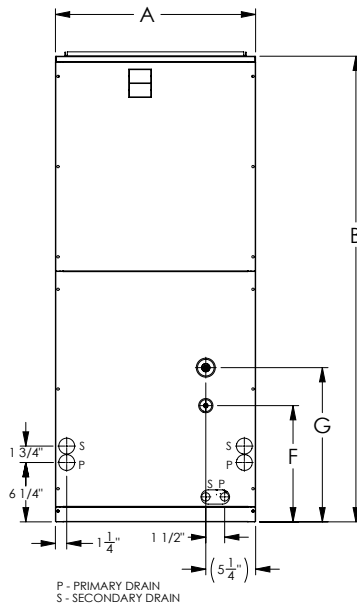
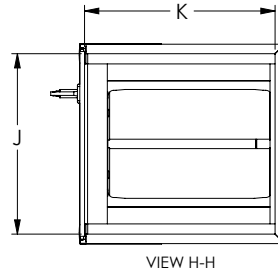
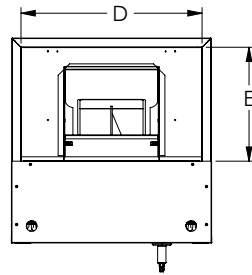

LEM SERIES AIR HANDLER

High Efficiency

Multi-Position, Aluminum Coil

LEM DIMENSIONS												
COIL SIZE	A	B	C	D	E	F	G	J	K	FILTER SIZE	SHIP WEIGHT	SKID QTY
LEM24A	14.5 [368]	40 [1016]	21.5 [546]	12.5 [318]	12 [304]	5 [127]	9 [229]	12.5 [218]	20 [508]	12X20	92	6
LEM24B	14.5 [368]	40 [1016]	21.5 [546]	12.5 [318]	12 [304]	9 [229]	5 [127]	12.5 [218]	20 [508]	12X20	92	6
LEM24C	14.5 [368]	40 [1016]	21.5 [546]	12.5 [318]	12 [304]	4 [102]	7 [178]	12.5 [218]	20 [508]	12X20	92	6
LEM24D	14.5 [368]	40 [1016]	21.5 [546]	12.5 [318]	12 [304]	5 [127]	9 [229]	12.5 [218]	20 [508]	12X20	92	6
LEM24E	14.5 [368]	40 [1016]	21.5 [546]	12.5 [318]	12 [304]	4 [102]	7 [178]	12.5 [218]	20 [508]	12X20	92	6
LEM24F/36A	17.5 [445]	46 [1168]	21.5 [546]	15.5 [394]	12 [304]"	10 [254]	13 [330]	15.5 [394]	20 [508]	14x20	115	4
LEM24G/36B	17.5 [445]	46 [1168]	21.5 [546]	15.5 [394]	12 [304]	4 [102]	7 [178]	15.5 [394]	20 [508]	14x20	115	4
LEM24H/36C	17.5 [445]	46 [1168]	21.5 [546]"	15.5 [394]	12 [304]	5 [127]	9 [229]	15.5 [394]	20 [508]	14x20	115	4
LEM24I/36D	17.5 [445]	46 [1168]	21.5 [546]	15.5 [394]	12 [304]	8 [203]	11 [279]	15.5 [394]	20 [508]	14x20	115	4
LEM24J/36E	17.5 [445]	46 [1168]	21.5 [546]	15.5 [394]	12 [304]	10 [254]	13 [330]	15.5 [394]	20 [508]	14x20	115	4
LEM36F/48A	21 [533]	49 [1245]	21.5 [546]	19 [483]	12 [304]	9 [229]	12 [305]	19 [483]	20 [508]	16X20	151	4
LEM36G/48B	21 [533]	49 [1245]	21.5 [546]	19 [483]	12 [304]	7 [178]	10 [254]	19 [483]	20 [508]	16X20	151	4
LEM36H/48C	21 [533]	49 [1245]	21.5 [546]	19 [483]	12 [304]	9 [229]	12 [305]	19 [483]	20 [508]	16X20	151	4
LEM36I/48D	"21 [533]	49 [1245]	21.5 [546]	19 [483]	12 [304]	10 [254]	14 [356]	19 [483]	20 [508]	16X20	151	4
LEM36J/48E	21 [533]	49 [1245]	21.5 [546]	19 [483]	12 [304]	12 [305]	16 [406]	19 [483]	20 [508]	16X20	151	4
LEM60A	"21 [533]	57 [1448]	21.5 [546]	19 [483]	12 [304]	18 [457]	22 [559]"	19 [483]	20 [508]	16X20	173	4
LEM60B	21 [533]	57 [1448]	21.5 [546]	19 [483]	12 [304]	"12 [305]"	16 [406]	19 [483]	20 [508]	16X20	173	4
LEM60C	21 [533]	57 [1448]	21.5 [546]	19 [483]	12 [304]	14 [356]	18 [457]	19 [483]	20 [508]	16X20	173	4
LEM60D	21 [533]	57 [1448]	21.5 [546]	19 [483]	12 [304]	16 [406]	20 [508]	19 [483]	20 [508]	16X20	173	4
LEM60E	21 [533]	57 [1448]	21.5 [546]	19 [483]	12 [304]	18 [457]	22 [559]	19 [483]	20 [508]	16X20	173	4
LEM48F/60F	24.5 [622]	57 [1448]	21.5 [546]	22.5 [572]	12 [304]	18 [457]	22 [559]	22.5 [572]	20 [508]	20X20	180	4
LEM48G/60G	24.5 [622]	57 [1448]	21.5 [546]	22.5 [572]	12 [304]	12 [305]	16 [406]	22.5 [572]	20 [508]	20X20	180	4
LEM48H/60H	24.5 [622]	57 [1448]	21.5 [546]	22.5 [572]	12 [304]	14 [356]	18 [457]	22.5 [572]	20 [508]	20X20	180	4
LEM48I/60I	24.5 [622]	57 [1448]	21.5 [546]	22.5 [572]	12 [304]	16 [406]"	20 [508]	22.5 [572]	20 [508]	20X20	180	4
LEM48J/60J	24.5 [622]	57 [1448]	21.5 [546]	22.5 [572]	12 [304]	18 [457]	22 [559]	22.5 [572]	20 [508]	20X20	180	4



373 Atascosita Road, Humble, TX 77396 | P 800-423-9007

www.AspenMfg.com