

Location: _____



RPC

RIGID PIPE COUPLINGS

Specification:

BEECO Style RPC Rigid Pipe Couplings provide a zero-flexibility combination of the piping system. The angle-pad design of 60 degrees adjust to steel pipes and roll/cut groove tolerances, positively clamping the pipe to resist flexural and torsion loads. Angle pad design and swing-over installation permit assembly by removing one nut/bolt and swinging housing over gasket, reducing assembly time and effort.

Function: Used in both fire protection lines and water distribution pipe lines and is compatible with Water, Diluted Acids, Oil Free Air, Waste Water, and High Temperature vapors.

Ratings:

2 1/2" - 4" 750 P.S.I., 5" - 6" 700 P.S.I.
 8" 600 P.S.I., 10" 500 P.S.I., 12" 400 P.S.I.
 Reducing Couplings 300 P.S.I.

Gasket:

Material: EPDM
 Temperature Rating: -30°C to +110°C; -20°F to +230°F
 Applications: Water, Diluted Acids, Oil Free Air, Waste, Water, High Temperature Vapors, etc.
 Design: "C" Type Gasket Standard design, provides a pressure responsive, leak-tight seal in both pressure and vacuum applications without the aid of external forces.
 Ductile Cast Iron conforming to ASTM A536, Grade 65-45-12 equal to QT 450-12.
 Surface Finish: Standard Dip Painted.
 Optional Fused Bonded Epoxy Coated in Various Colors
 Vacuum applications without the aid of external forces.

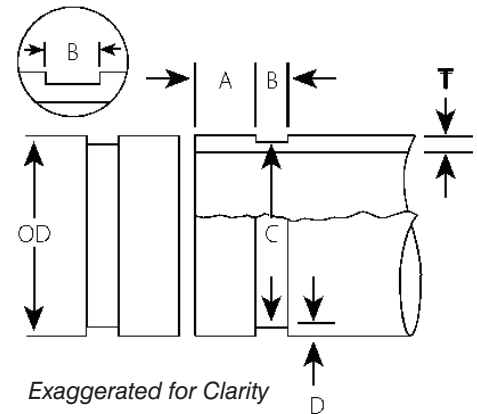

Standard Cut Groove

Model No.	Pipe	OD MM	Outside Dia. Maximum	Gasket Seat A	Groove Width B	Groove Dia. Max C	Groove Dia. Min C	Groove Depth D
RPC2.00	2"	60.300	2.400" (61)	0.625" (15.9)	0.313" (8)	2.250" (57.2)	2.235" (56.8)	0.063" (1.6)
RPC2.50	2 1/2"	73.100	2.900" (73.8)	0.625" (15.9)	0.313" (8)	2.720" (69.1)	2.702" (68.6)	0.078" (2)
RPC3.00	3"	88.900	3.500" (89.8)	0.625" (15.9)	0.313" (8)	3.344" (84.9)	3.326" (84.5)	0.078" (2)
RPC4.00	4"	114.300	4.550" (115.5)	0.625" (15.9)	0.375" (9.5)	4.334" (110.1)	4.314" (109.6)	0.084" (2.2)
RPC6.00	6"	168.300	6.700" (170)	0.625" (15.9)	0.375" (9.5)	6.455" (164)	6.433" (163.4)	0.084" (2.2)
RPC8.00	8"	219.100	8.060" (204.8)	0.750" (19.1)	0.438" (11.1)	8.441" (214.4)	8.416" (213.8)	0.093" (2.4)
RPC10.00	10"	273.000	10.810" (274.7)	0.750" (19.1)	0.438" (11.1)	10.562" (268.3)	10.535" (267.6)	0.093" (2.4)
RPC12.00	12"	323.900	12.810" (325.5)	0.750" (19.1)	0.438" (11.1)	12.531" (318.3)	12.500" (317.5)	0.109" (2.8)

Job Name: _____ Page No: _____
 Section No: _____ Contractor: _____
 Schedule No: _____ Purchase Order No: _____

BEECO reserves the right to make changes in material and design without formal notice and obligation.

USA: 1-800-465-2736 www.beecobackflow.com CAN: 1-800-387-3880